

AEC DOWNSTAIRS

CYPRESS POINT DR

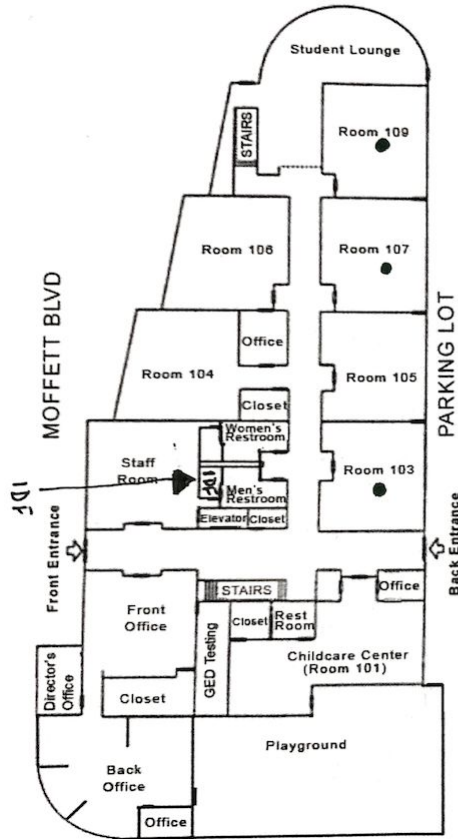

AEC UPSTAIRS

CYPRESS POINT DR

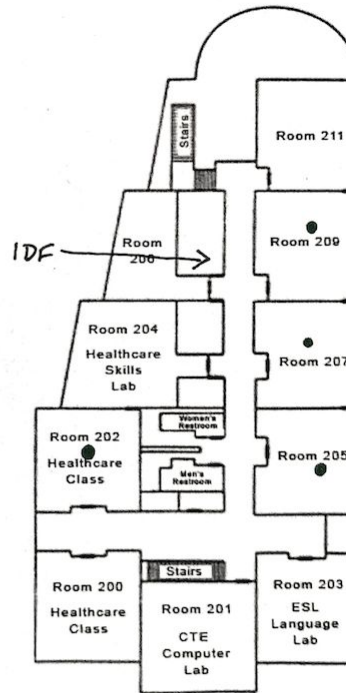

| Room # | Scope of Work | Wire Length |
|--------|--|-------------|
| 103 | Pull new wire from IDF (MUR); re-locate current access point as pictured | 100' |
| 107 | Pull new wire from IDF (MUR); mount access point (owner furnished) | 150' |
| 109 | Pull new wire from IDF (in office); mount access point (owner furnished) | 100' |
| 202 | Pull new wire from IDF (tech ctr); mount access point (owner furnished) | 50' |
| 205 | Pull new wire from IDF (tech ctr); mount access point (owner furnished) | 100' |
| 207 | Pull new wire from IDF (D5); mount access point (owner furnished) | 50' |
| 209 | Pull new wire from IDF (D5); mount access point (owner furnished) | 100' |

NOTES:

- **REMOVE** old AP wiring if exists from IDF to classroom when new wire being pulled
- **Provide patch cable from new drop to AP**
- In rooms where a ceiling-mounted projector exists; ensure AP is at least 5' away from the projector.
- In rooms where ceiling HVAC units exist, ensure AP is at least 15' away from unit.
- In rooms where new wire is pulled from IDF, Include service loop in the drop-ceiling area for each cable run when/where available

TOTAL WIRE LENGTH NEEDED FOR THIS WING: 650 FEET